



# **INSTALLATION & OPERATING INSTRUCTIONS**



**NERIS500 & NERIS750**

## **IMPORTANT WARNINGS**

Dear Customer:

Thank you for purchasing our NERIS Towel Rail. As with all our products they are manufactured to the highest quality using the finest materials that gives us confidence that you will have many years of good use and comfort from your product.

NERIS Towel Rails are extremely safe, *Virtually Silent* easy to install and do not require any special maintenance. They are made of aluminum, a material of high durability. Before use for the first time, *carefully read* these instructions.

## **GENERAL SAFETY INSTRUCTIONS**

1. Please carefully read these instructions before using the device for the first time. Please keep these instructions, Your Guarantee, and your Invoice in the unlikely you have to make a warranty claim on the product.
2. **The Guarantee will be invalidated if the heater is not installed as per the instructions within this manual.**
3. Before connecting the appliance, make sure the mains voltage is the 230 Volts, and corresponds to the marked label of the appliance.
4. Check that the power is sufficient to supply the appliance. The total draw of the Towel Rail currents must not exceed the capacity of the circuit and the breaker that protects them.
5. This Towel Rail cannot be used in rooms with presence of gases or other flammable products (glues, etc...).
6. **WARNING:** To prevent overheating, do not completely cover the heater and do not use it to dry wet clothes.
7. Make sure the power cable or other objects does not come in contact with the Towel Rail surface while in operation.
8. If the power cable becomes damaged it must be replaced with a genuine replacement part supplied from the manufacturer and installed by a fully qualified electrician. Failure to comply may cause danger to your safety and will void the product warranty.
9. Check the device and the supply cord regularly. Do not use the device if the cable has been damaged.

10. **PRECAUTION:** Some parts of this product can reach high temperatures and could cause burns. Pay special attention when children or vulnerable people are around to protect them from the heater.
11. Do not mount the heater directly under a power socket.
12. Children under the age of three should not be allowed to touch or play with Towel Rail and should always be supervised.
13. This device can be used by children under 8 years of age, as well as by people with reduced physical, sensory or mental capabilities when suitably supervised and only when they have been provided the instructions regarding the use of the device and have understood the risks that could derive from it. Cleaning must only be carried out by an appropriate adult using a damp cloth with a non-abrasive cleaner, abrasive cleaners may damage the product.
14. Children between 3 and 8 years should not turn the heater on or off, unless this is installed or placed in a normal position and that children are under proper supervision or have received instructions regarding the use of the device as security and they have perfectly understood the potential dangers. Children between 3 and 8 years old should not connect, adjust, or clean the appliance or perform any maintenance measure.
15. **Warning:** Do not use this heater near baths, showers, or swimming pools. It should not be possible to access the device's controls from a bath, shower or any other surface that is in contact with water.(the use of this heater in zones 0 or 1 in bathrooms is totally prohibited:!  
(Seek advice from a qualified electrician).
16. For greater safety, this appliance is provided with a device that interrupts its operation in the case of overheating.
17. This Towel Rail has been designed exclusively to be fixed to the wall. For further information on the fixing systems, Go to Section "INSTALLATION AND WALL MOUNTING" Within this manual.
18. Do not use accessories that have not been recommended by the manufacturer, as they could entail a potential risk to the user and damage the device. Use only original accessories.
19. Keep all the packaging elements (plastic bags, cardboard, and polyethylene) out of the reach of children, as it can be potentially dangerous and could cause suffocation.

20. This device has been designed for domestic and light commercial use. This device has not been designed for industrial use. **It must not be used Outdoors, in Greenhouses or in Animal or Agricultural environments.** Keep the heater away from excessive heat, direct sunlight and in an environment that has a constant humidity. Under No Circumstances should the heater be immersed in water or use the device with wet hands. In the case of humidity or water entering the device, it should be immediately disconnected from the power supply and left to fully dry. Do Not touch any Wet parts of the heater before it has been isolated from the main power supply.
21. Do not attempt to service the device yourself. Contact a qualified technician for any service or repair work.
22. Respect the "SPECIFIC SAFETY INSTRUCTIONS FOR THIS APPLIANCE" listed below.
23. WARNING: To avoid danger to very young children or people with impaired capacity. This appliance should be installed at higher level to avoid anyone touching the heater.
24. WARNING: This appliance is only intended for drying towels that have become damp with fresh water and not any other substance as this could result in damaging the heater and invalidate its warranty.

### **SPECIFIC SAFETY INSTRUCTIONS FOR THIS DEVICE**

- The appliance must remain in a vertical position.
- Make sure the appliance is always secured. Please adhere to the installation clearances indicated in this manual.
- The Towel Rail is designed to be hard wired in accordance with BS7671 for Bathrooms or Shower Rooms. Follow the instructions in "INSTALLATION".
- **The Guarantee will be invalidated if the heater is not installed as per the instructions within this manual.**

### **INSTALLATION**

- During the first Start Up the heater might create a slight odour and some slight expansion noise due to some internal part movement. This is normal and you must provide adequate ventilation when this occurs. The odours are momentary and will quickly dissipate in a well-ventilated area.
- Fix the Towel Rail onto a firm wall and making sure it is level.
- The Towel Rail must be a minimum distance of 15cm from any combustible material.

- Allow for a minimum distance of 1m from the front of the unit to any obstacles that could hinder its operation.
- Keep a minimum distance of 15 cm between the appliance and the side walls and any other obstacles (walls, for example) that may affect its function.
- **WARNING:** When this appliance is installed in a bathroom, it must be installed within Zone 2 in accordance with BS7671. Requirements for Electrical Installations, Section 701. The installation of this appliance within Zones 0 or 1 of a bathroom is totally prohibited. Figure 2 bellow is only for information purposes, we suggest you contact a professional electrician for installation of your heater.

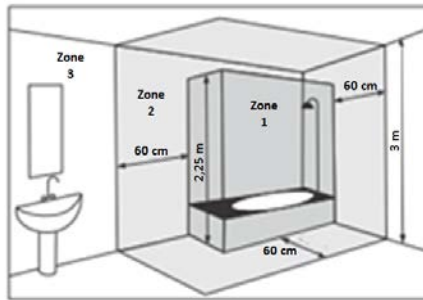

Zone 1: Appliances supplied to Safety Extra Low Voltage (SELV).  
Zone 2: Electrical Appliances Class II – IP X24

**Fig.2**

## **WALL-MOUNTING**

The towel radiator is equipped with the following components:  
- 4 towel radiator suspension brackets as shown in (Fig 1).

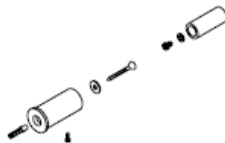

**Fig. 1**

1. Cut and place the template on the wall at a minimum recommended height of 600mm. (This is for ease of controller use) The heater can be mounted lower if this is your preference however care should be taken where young children are present.

2. Mark the position of the 4 holes on the wall.

3. Drill 4 holes suitable for 8 mm wall plugs.

4. Screw the larger diameter brackets ( $\varnothing$  26) as shown in Fig 2.  
2. Fix using the screws, washers and plugs provided as shown in Fig. 2.



Fig. 2

5. Screw the smaller diameter brackets ( $\varnothing$  19) onto the heater with the 4 x M4 screws and 4 x M4 washers as shown in Fig 3.

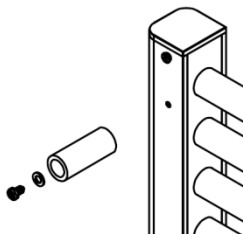

Fig. 3

6. Insert the brackets ( $\varnothing$  19) fixed to the heater into the brackets ( $\varnothing$  26) fixed to the wall and secure using the fixing screws as shown in Fig 4 & 5.

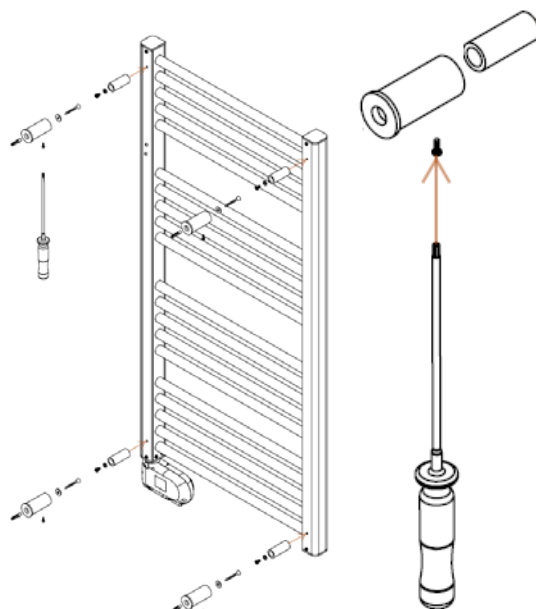
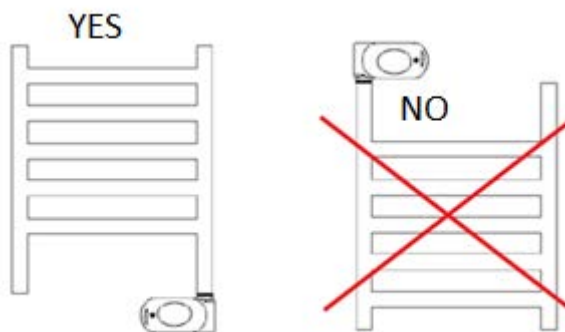

Fig. 4

Fig. 5



## **ELECTRIC SUPPLY CONNECTION**

This appliance is equipped with a supply cable **H05V2V2-F 2x1.0mm<sup>2</sup>** that should be connected to a fused spur in accordance with BS7671. Requirements for Electrical Installations, Section 701.

It is recommended that the cable ends are crimped before connecting the heater to the spur. This is to prevent any loose strands of flex being present within the connection.

This appliance does not require earthing connection as it is double insulated.

Contact a fully qualified electrician for assistance.

## **TECHNICAL CHARACTERISTICS**

| Type                        | NERIS 500   | NERIS 750    |
|-----------------------------|-------------|--------------|
| Rated Voltage               | 230 V~      | 230 V~       |
| Rated Frequency             | 50 Hz       | 50 Hz        |
| Rated Power Input           | 500 W       | 750 W        |
| Electrical Protection Class | II          | II           |
| IP Protection Deg.          | IP24        | IP24         |
| Dimensions (LxHxD) (mm)     | 505x780x100 | 505x1140x100 |
| Weight (kg)                 | 3,8         | 5,1          |

## **HOW TO PLACE TOWELS**

Hang the towels on the heater horizontally across the rail from back to front.

It is recommended to use the upper horizontal tube of each tube set.

**Do Not Cover completely as this will cause the rail to overheat!**



# PROGRAMMABLE DIGITAL THERMOSTAT

## Introduction

There are 7 operational modes: Comfort, Night, Frost, Pilot Wire, Program, 2hr Boost, Stand-by.

**"Comfort" mode:** The thermostat keeps the room temperature at the value set by the user.

**"Night" mode:** The electronic control keeps the room temperature to a level below the configured "Comfort" value.

**"Frost" mode:** The electronic control keeps the room temperature above 7°C.

**"Pilot Wire" mode:** The operations of device are controlled through the signal received from the "Pilot Wire" system.

**"2hr Boost" mode:** The electronic control powers the heating element for a period of 2 hours independently of the configured temperature. At the end of the 2-hour time period, the device returns to previous operational mode. For safety reasons, during the 2-hour time period the room temperature is automatically controlled in order not to exceed 32°C.

**"Program" mode:** The electronic control operates according to a daily/weekly program. The program is user defined.

**"Stand-by":** The electric resistance is not powered, and all lights are turned off, however the device is still operative.

## Further features:

- Large display showing the configured temperature, time, program and current operational mode.
- The user according to their needs can configure the daily/weekly program.
- The "Open Window Detection" function enables detecting of an open window by sensing a sudden decrease of the temperature in the room. In such a case, the device deactivates the heating element for a maximum of 30 minutes or until an increase of the room temperature reveals that the window has been closed.

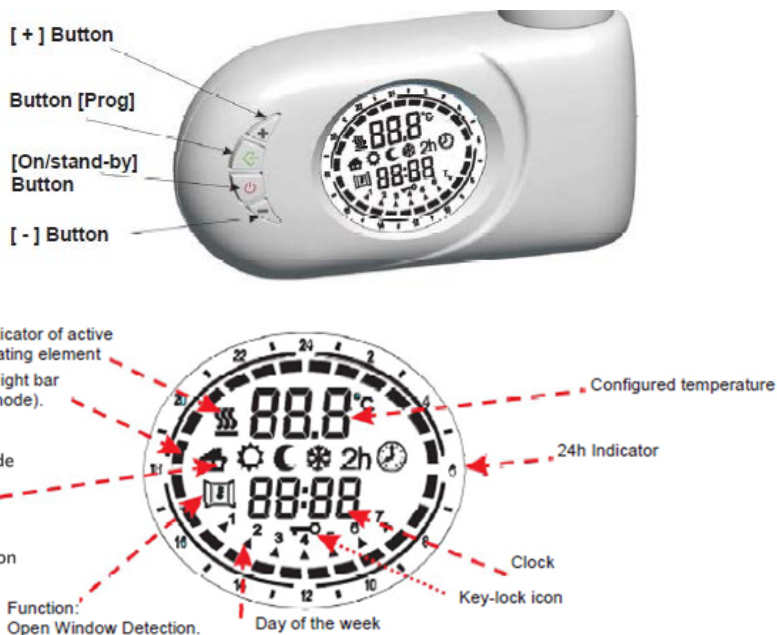

# 1. POWER ON / STAND-BY

## 1. POWER ON / STAND-BY

Press the **[On/Stand-by]** key to turn on the device or to enter the "Stand-by" mode.

When activated, the bottom part of the display shows the current time, while the configured operative mode and the temperature are shown in the upper part. When in "Stand-by" mode current time, day of the week and the message: " Stb" are displayed.

NOTE: When the device goes into "Stand-by" mode it beeps twice for 0.5s. When the device is activated it beeps once for 1s.

Example in "Comfort" mode.



Example in "Stand-by" mode.



## 2. “COMFORT” and “NIGHT” MODES

Two different levels of temperature can be set:

- "COMFORT" temperature: It is the temperature used for "Program Timer", "Pilot Wire" and "Comfort" modes.

- "NIGHT" temperature: It is the temperature used for the "Night" and "Program Timer" modes.

The desired temperature can be set pressing the [+] e [-] buttons. The range of configurable temperature is 7°C - 32°C.

**IMPORTANT!**

The temperature of "Night" mode must be below to the “Comfort” mode temperature. For this reason, the

“Night” mode temperature can be set to a value between 7°C and the (configured "Comfort" mode temperature - 0.5°C).

The temperature of "Comfort" mode can be configured in the whole (Night temperature + 0.5°C) ÷ 32°C range.

## 3. OPERATING THE DEVICE

Press the **[PROG]** button to select the desired operative mode. An icon on the display indicates the selected operating mode, according to the following table:

|   |   |   |   |   |
|---|---|---|---|---|
|  |  |  |  |  |
| Comfort   | Night   | Frost Protection  | Boost   | Program   |

### COMFORT MODE

The "Comfort" stably maintains the room temperature to a selected value. To set this operative mode:

- Press the **[Prog]** button until the display shows the “Comfort” icon

- Set the desired temperature through **[+]** and **[-]** buttons.

## NIGHT MODE

The "Night" mode sets a value of temperature below the "Comfort" temperature value.

It is suggested to set this operating mode during the night or when the room is not occupied for 2 or more hours.

-Press the **[Prog]** button until the display shows the "Night" icon

-Set the desired temperature through **[+]** and **[-]** buttons.

## FROST PROTECTION

In "Frost" mode the temperature is fixed to 7°C. The device activates the heating element when the room temperature falls below 7°C. It is suggested to set this operating mode when the room is not occupied for several days. Press the **[Prog]** button until the display shows the "Frost" icon

## 2HR BOOST MODE

The "Timer 2h" mode can be used to quickly warm up the room or to speed up towel drying.

-Press the **[Prog]** button until the display shows the "2h" icon.

The device is activated at the maximum power for 2 hours, up to a maximum room temperature of 32°C. The

"2hr Boost" mode is automatically deactivated after a period of 2 hours and the device returns to the operative

mode previously set. The user can switch to another operative mode at any time by simply pressing the **[PROG]** button.

**PILOT WIRE MODE** (Only for product versions equipped with "Pilot Wire". Only France)

In "Pilot Wire" mode the device is managed by a central control system that sets the operating mode for all the connected devices. The device operates with the most advanced "Pilot Wire" system with six commands, which allows the following functions:

1.Standby: power off the heating element, the device remains active.

2.Comfort: maintains the "Comfort" temperature set by the user.

3.Eco: maintains the room temperature 3,5°C below the "Comfort" temperature.

4.Anti-freeze: maintains the room temperature at 7°C.

5.Eco-1: maintains the room temperature 1°C below the "Comfort" temperature.

6.Eco-2: maintains the room temperature 2°C below the "Comfort" temperature.

The user can set the desired temperature on the device:

-Press the **[Prog]** button until the "Pilot Wire" icon is displayed.

Set the desired temperature through the **[+]** and **[-]** buttons.

## PROGRAM TIMER MODE

This operating mode allows the user to configure different temperature values for each hour of each day of the week. The "Comfort" / "Night" temperatures and the related time intervals can be thus programmed.

-To activate this function, press the **[PROG]** button until the "Timer" icon is displayed.

### Programming the "Programmer" mode

a) Setting the current day of the week and time

- Enter into "Stand-by" mode and press the **[-]** button at least 3 seconds.
- On the upper part of the display the message "Set" will be displayed
- To set the day and time press the **[+]** button until the bottom part of the display the message "TED" is displayed (see picture).

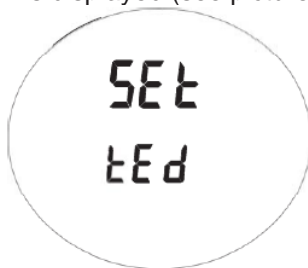

Press the **[Prog]** button to enter the editing mode

- The blinking arrow indicates the currently selected day: Pressing the **[+]** / **[-]** buttons the desired day can then be set

- Press again the **[Prog]** button to confirm the selected day. After that, the procedure for entering the time starts and the display shows the currently selected time. "Hours": Use the **[+]** and **[-]** buttons to set the correct hour and confirm the selected value pressing the **[Prog]** button.

Minutes: Same procedure as for the hours. Confirm the selected value by pressing the **[Prog]** button.

- At the end of the procedure, the thermostat returns into "Stand-by" mode.

### b) Setting the program for the "Program timer" mode

- Enter into "Stand-by" mode and press the **[-]** button at least 3 seconds.
- On the upper part of the display the message "Set" will be displayed
- To set the day and time press the **[+]** button until the bottom part of the display the message "Prog" is displayed (see picture).

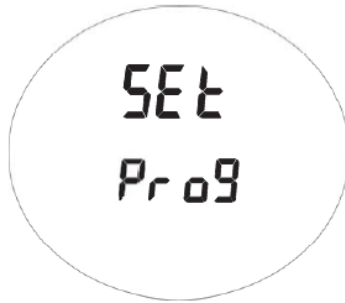

- Press the **[Prog]** button to enter the editing mode
  - Now a time sequence can be defined for each day of the week.
- The procedure starts with day 1, and the desired sequence can be configured with the **[+]** and **[-]** buttons:
- For each hour of the day, it is then possible to assign either the “Comfort” temperature (full bar indication displayed) by pressing the **[+]** button or the “Night” temperature (empty bar) by pressing the **[-]** button (see picture).

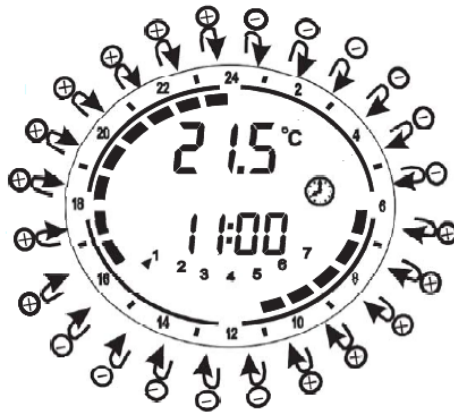

Press **[PROG]** to confirm the entered configuration for day 1, and repeat the same procedure for the remaining 6 days of the week.

## KEY LOCK

It is possible to lock the buttons of the device to avoid inadvertent modifications of the settings.

Press together the **[PROG]** buttons for 3 seconds to lock all the buttons except the **[On/Stand-by]** button. The key-lock icon is activated on the display.

To unlock the buttons press again together the **[PROG]** buttons for 3 seconds. The key-lock icon disappears on the display



### “Open Window Detection” function

The “Open Window Detection” function enables detecting of an open window by sensing a sudden decrease of the temperature in the room. In such a case, the device deactivates the heating element for a maximum of 30 minutes or until an increase of the room temperature reveals that the window has been closed.

To activate this function:

- Enter into “Stand-by” mode.
- Press the **[+]** button for 3 seconds.
- Press the **[+]** button to activate / deactivate the function
- Press the **[Prog]** button to commit and return into “Stand-by” mode.

When this function is enabled, the “Open Window” icon on the display is lit.

When the device detects that the window is potentially opened, the “Open Window” icon starts blinking

When the function is disabled the “Open Window” icon is not shown on the display.

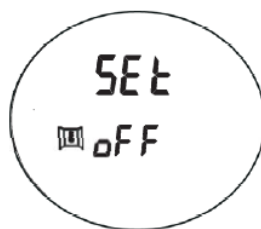
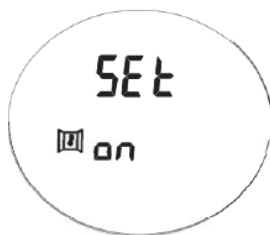

**Note:** The device could fail in detecting an opened window e.g. if the thermostat is located on an isolated area of the room and far from air currents or if the thermostat is placed close to an external heating source, or if the temperature variation in the room is too slow.

## THERMAL SAFETY

In the case of overheating, a safety device automatically cuts the radiators operation. After cooling the radiator will automatically reset.

## MAINTENANCE

Your radiator requires no regular maintenance, however, to ensure its good operation:

Always disconnect the device from the mains before performing any cleaning or maintenance operation.

Let it cool down before cleaning.

Do not use detergent, solvent, abrasive products or any other chemical product to clean the radiator.

**NEVER immerse the device in water or any other liquids.**

You can use a vacuum or flexible brush to clean the air grilles. This maintenance must be carried out regularly to ensure optimum performance. Ensure the radiator is totally dry before turning it back on.



## EU Declaration of Conformity



|   |   |
|---|---|
| Product:  | TOWEL RAIL  |
| Trademark:  |  |
| Models:   | NERIS 500, NERIS 750  |
| Batch & Serial No.:   | Mx YYDDD-XXX <sup>(1)</sup>   |
| (1) Explanation of code "Lot & Serial No."<br>Batch = Mx YYDDD; where: Mx = Assembly Line No. YY = year (15,16,17...99) DDD = Correlative day (001,..., 365)<br>Serial No. = XXX (001,..., 999) |   |

We:

**HERMANOS JULIÁN M., S.L.**

Oficina: Esposos Curie,44 / Fábrica: Gutenberg,91-93  
Polígono Industrial "Los Villares". 37184 Villares de la Reina. Salamanca. España  
Tf.+34 923 222 277 +34 923 222 282. Fax +34 923 223 397  
<http://www.hjm.es>

Hereby declare, that the following equipment complies with all the essential requirements for health and safety of European Directives.

**2014/30/EC EMC DIRECTIVE 2014/35/EC LV DIRECTIVE**  
**2011/65/UE RoHS DIRECTIVE 2009/125/EC (ErP Directive)**

With reference to the application of the following standards: / Em aplicação das seguintes normas:

|   |   |
|---|---|
| <b>2014/30/EC EMC DIRECTIVE</b>                           | EN 55014-1:2006 + A1:2009 + A2:2011<br>EN 55014-2:1997 + A1:2001 + IS1:2007 + A2:2008 ==> Cat. 2<br>EN 61000-3-2:2014<br>EN 61000-3-3:2013  |
| <b>2014/35/EC LV DIRECTIVE</b>                            | EN 60335-2-30:2009 + CORR:2010 +A11:2012<br>EN 60335-1:2012 +AC:2014 +A11:2014 + A13:2017<br>EN 60335-2-43:2004<br>EN 62233:2008 +CORR:2008 |
| <b>2011/65/UE RoHS DIRECTIVE</b>                          | EN 62321-1:2013   |
| <b>2009/125/EC (ErP Directive)</b><br><b>(2005/32/EC)</b> | UE 2015/1188  |

## ECDESIGN TABLE

| Models  | NERIS 500   | NERIS 750 |
|---|---|-----------|
| Heat output   |   |           |
| Nominal heat output<br>( $P_{nom}$ )  | 0.5 kW  | 0.75kW    |
| Maximum continuous<br>heat output<br>( $P_{max,c}$ )  | 0.5 kW  | 0.75kW    |
| Auxiliary electricity consumption   |   |           |
| At nominal heat output<br>( $el_{max}$ )  | 0.0005 kW   | 0.0005 kW |
| At minimum heat output<br>( $el_{max}$ )  | 0.0005 kW   | 0.0005 kW |
| In standby mode<br>( $el_{sb}$ )  | 0.0005 kW   | 0.0005 kW |
| Type of heat output/room<br>temperature control:  | Electronic room<br>temperature control plus<br>week timer                                   |           |
| Other control options:  | Room temperature control,<br>with open window<br>detection.<br>With adaptive start control. |           |
| <b>HERMANOS JULIÁN M., S.L.</b><br>Oficina: Esposos Curie,44 / Fábrica: Gutenberg,91-93<br>Polígono Industrial “Los Villares”. 37184 Villares de la Reina.<br>Salamanca. España<br>Tf.+34 923 222 277 +34 923 222 282. Fax +34 923 223 397<br><a href="http://www.hjm.es">http://www.hjm.es</a> |   |           |

## RECYCLING (Disposal of the product at the end of its useful life)



According to European Directive **2012/19/UE**, on waste electrical and electronic equipment (WEEE), old electrical household appliances cannot be disposed of in the usual municipal containers; they have to be collected separately to optimise the recycling of the components and materials that comprise it, and reduce the impact on human health and the environment.

The crossed-out wheeled bin is marked on all Electrical and Electronic products, to remind the consumer of their obligation dispose of them separately.

The consumer must contact the local authority or the vendor to learn about the correct disposal of his/her old electrical household appliance.

Fábricado por / Fabricado por



**HERMANOS JULIAN M., S.L.**

☒ Fábrica: Gutenberg,91-93

Polígono Industrial "Los Villares"

ES-37184 Villares de la Reina . Salamanca . Spain

☎ +34 923 222 277 - +34 923 222 282

☎ Fax: +34 923 223 397

Web: **www.hjm.es**

ESB-37295664